

COMPONENT LIST	
PRODUCT	QTY
RootSpace STRUCTURAL SOIL CELL/AIR DECK	VARIABLE
FG3030 FilterGrid BI-AXIAL FILTER LAYER	VARIABLE
RRPREC1 RootRain PRECINCT SINGLE INLET	VARIABLE
RRARB2 RootRain ARBORVENT DUAL INLET	VARIABLE
RER300 ReRoot LINEAR RIBBED R/BARRIER	VARIABLE
RS400 RootStop BARRIER	VARIABLE

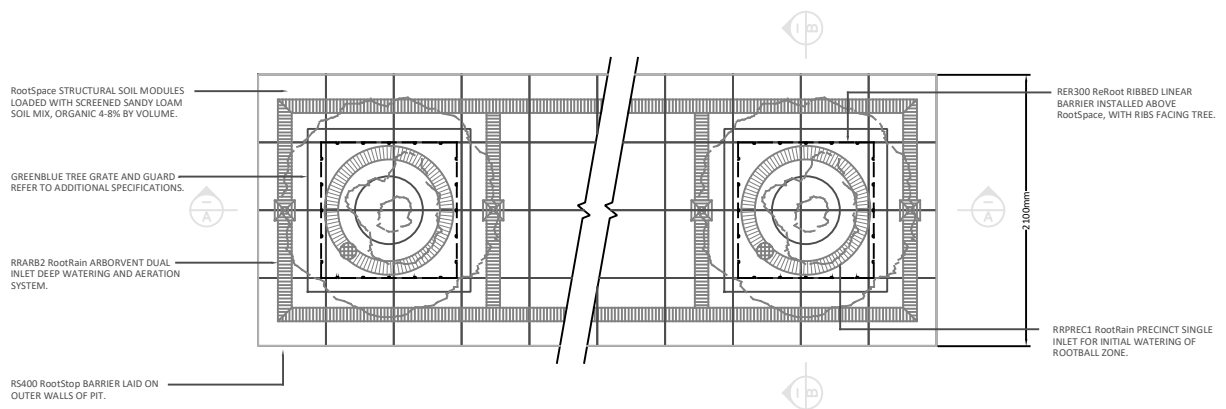

LINKED TREEPIT - PLAN

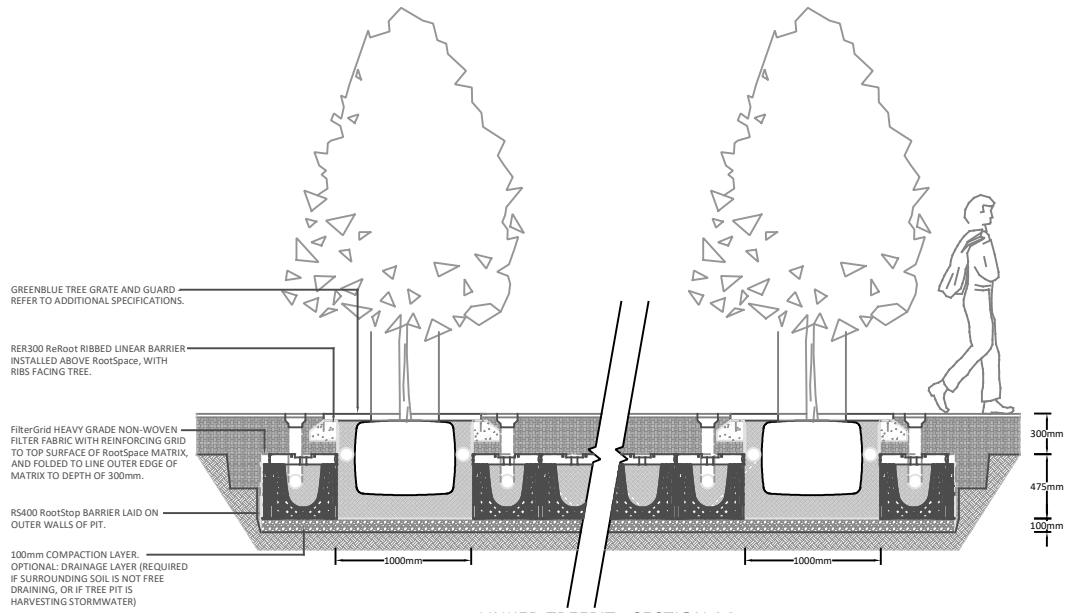

LINKED TREEPIT - SECTION AA

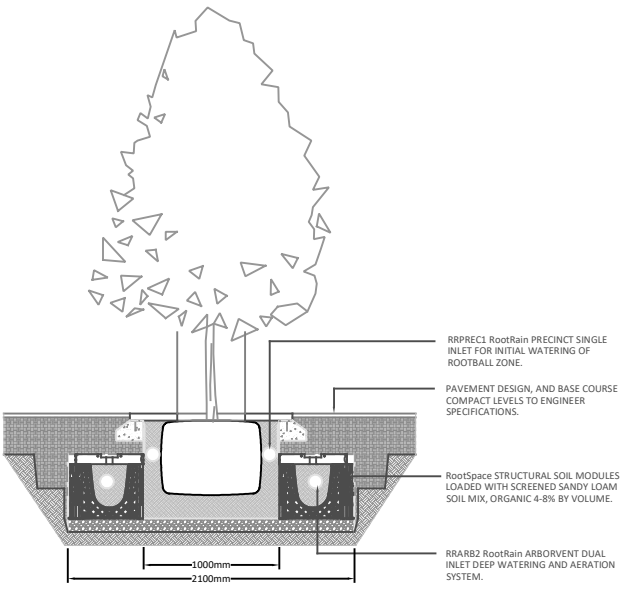

LINKED TREEPIT - SECTION BB

- INSTALLATION/EXCAVATION TIPS
1. ADD 5% TO OUTER PLAN DIMENSIONS WHEN EXCAVATING PIT.
  2. ALWAYS CHECK PIT DIMENSIONS AT BASE OF PIT, ENSURING SIDES ARE CLEAN AND SQUARE.
  3. LEVEL AND SCREED DRAINAGE LAYER PRIOR TO PLACEMENT OF CELLS.

NOTE : ENSURE THE PIT BASE IS SCREEDED, LEVELLED AND COMPACTED PROPERLY BEFORE PLACING CELLS ON BASE, TO ALLOW FOR EASE OF INSTALLATION OF OVERALL MATRIX.

NOTE : ADEQUATE DRAINAGE FROM BASE OF TREEPIT TO BE PROVIDED IF DESIGN INCORPORATES WSUD PRINCIPLES, OR IF SITE CONDITIONS REQUIRE.



DISCLAIMER	
All foundation details to be verified by a qualified engineer. The manufacturer disclaims liability resulting from any loss or damage incurred from their products, or their installation methods, either direct or consequential.	
Designed: JS	Checked: -
Date: 03/09/12	Approved: -
Scale: AS SHOWN	

No.	Revision:	Date:

Title
LINKED TREEPIT W/TREE GRATE 1m <sup>2</sup> /m DETAIL PLANS
Drawing No. <span style="float: right;">Rev. A</span>