

COMPONENT LIST	
PRODUCT	QTY
RootSpace STRUCTURAL SOIL CELL/AIR DUCT	528/116
FG3030 FilterGrid BI-AXIAL FILTER LAYER	55yd ²
RRPREC1 RootRain PRECINCT SINGLE INLET	1
RRARB2 RootRain ARBORVENT DUAL INLET	3
RER300 ReRoot LINEAR RIBBED R/BARRIER	15'
RS750 RootStop BARRIER	88.9'

SOIL VOLUME GUIDE: APPROX 982.64ft³ OF SOIL (±5%), DEPENDING ON SOIL TYPE AND EXCAVATION VARIATIONS

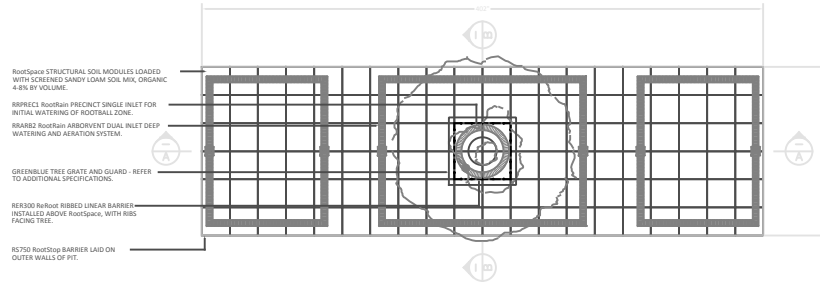

LINEAR TREEPIT - PLAN

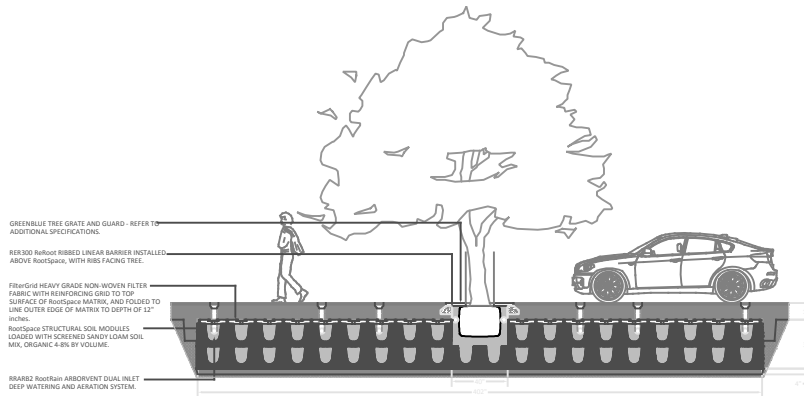

LINEAR TREEPIT - SECTION AA

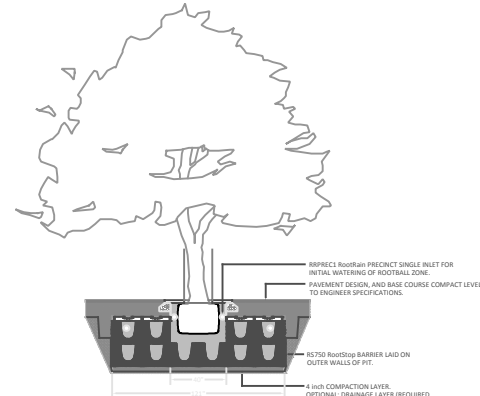

LINEAR TREEPIT - SECTION BB

NOTE : ENSURE THE PIT BASE IS SCREEDED, LEVELLED AND COMPACTED PROPERLY BEFORE PLACING CELLS ON BASE, TO ALLOW FOR EASE OF INSTALLATION OF OVERALL MATRIX.

NOTE : ADEQUATE DRAINAGE FROM BASE OF TREEPIT TO BE PROVIDED IF DESIGN INCORPORATES WSUD PRINCIPLES, OR IF SITE CONDITIONS REQUIRE.



DISCLAIMER	
All foundation details to be verified by a qualified engineer. The manufacturer disclaims liability resulting from any loss or damage incurred from their products, or their installation methods, other than as stated on these drawings.	
Designed: JS	Checked:
Date: 03/02/2012	Approved:
Scale: AS SHOWN	

No.	Revision:	Date:

Title	
LINEAR TREEPIT w/TREE GRATE 985 cu ft DETAIL PLANS	
Drawing No.	Rev. A

- INSTALLATION/EXCAVATION TIPS
1. ADD 5% TO OUTER PLAN DIMENSIONS WHEN EXCAVATING PIT.
 2. ALWAYS CHECK PIT DIMENSIONS AT BASE OF PIT, ENSURING SIDES ARE CLEAN AND SQUARE.
 3. LEVEL AND SCREED DRAINAGE LAYER PRIOR TO PLACEMENT OF CELLS.