

All dimensions and details are approximate and must be checked on site not scaled from the drawing.  
No part of this drawing can be reproduced or transmitted by any means electronic or mechanical including photocopy without prior permission in writing from GreenBlue Urban.  
**Package includes the following GreenBlue Urban products per tree:**

- GBURAC600A RootSpace uprights - 132 No. 500mm x 500mm x 600mm per tree
- GBURAC500A RootSpace Airflow deck - 56 No. 500mm x 500mm x 70mm
- Rootsoil 20 to fill RootSpace and RootDirector spaces (including root ball volume) - allow 10 cu. m per tree. Additional allowance needs to be made for settlement
- RootStart Mycorrhiza - apply to tree pit at time of planting in accordance with manufacturer's recommendations - allow 200g per tree
- RRHYDR1A RootRain Hydrogrille single inlet aeration/irrigation system with cast inlet
- RRARBV150A Arborvent 150 Double inlet aeration/irrigation system with cast inlets including 2m 100mm diameter pipe
- RD1000-RS RootSpace RootDirector - medium
- GLTWGNA twinwall geonet - 18 sq. m
- GRN20 plastic open reinforcing mesh, 20mm aperture - 38 sq. m
- SASLCB Arborgyu strapped anchor system - large

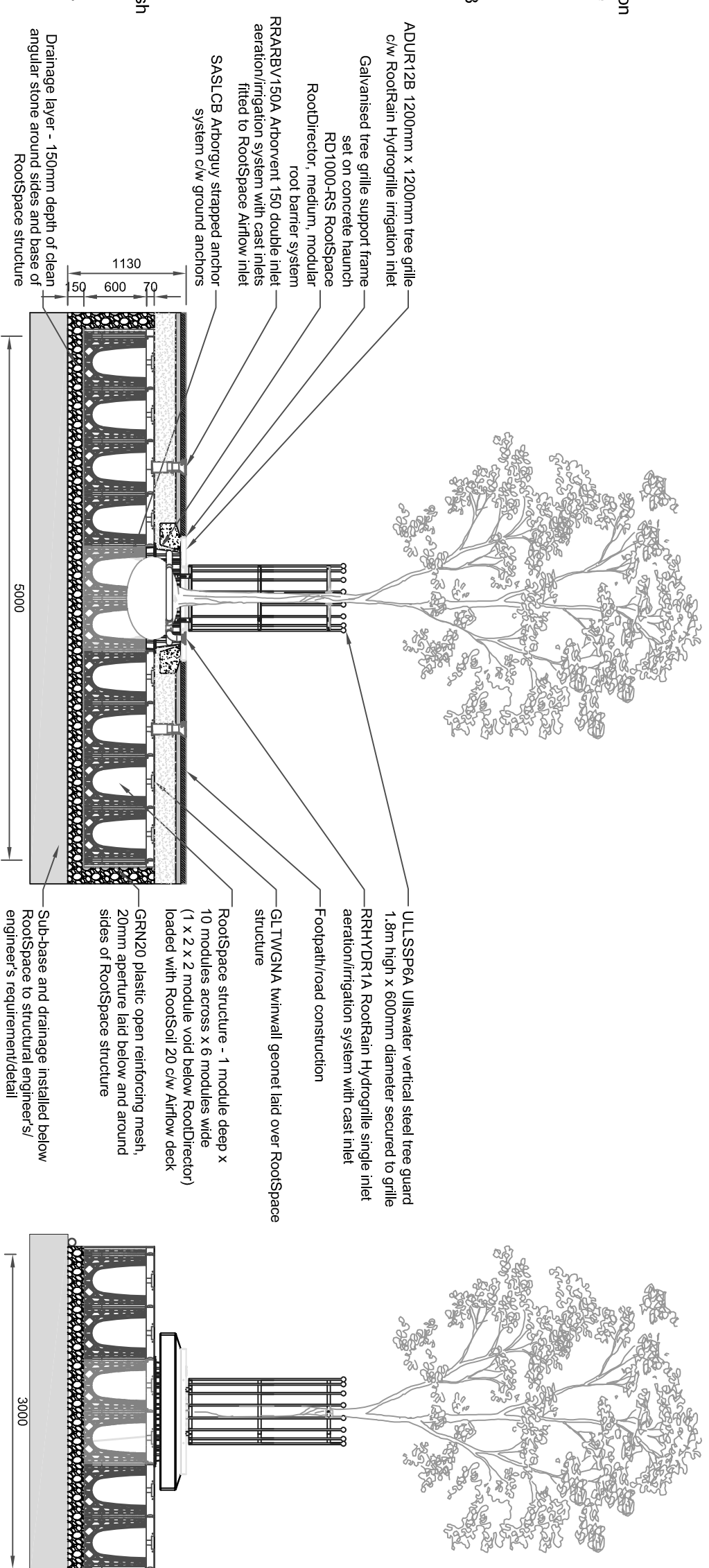
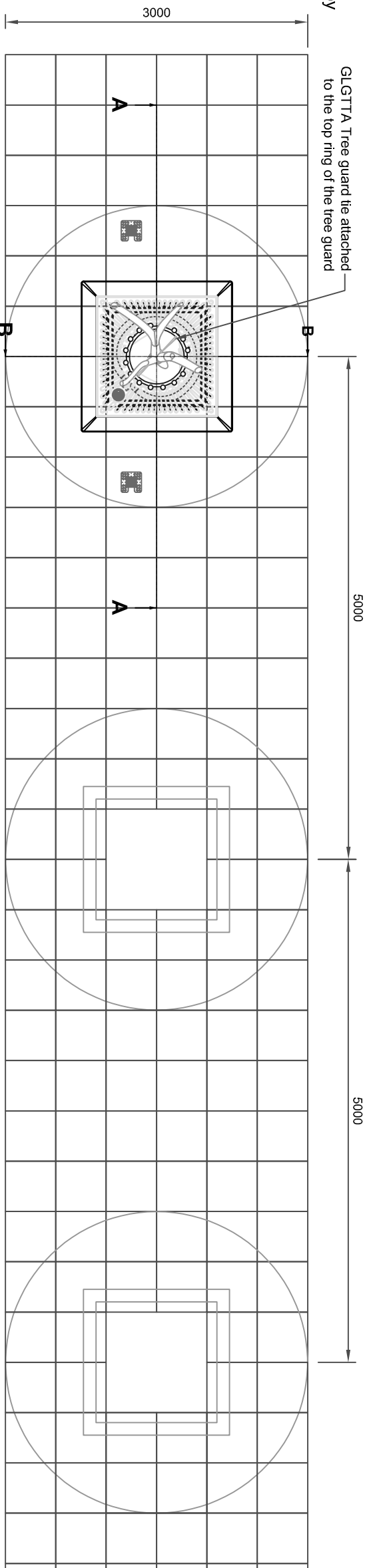

**Structural engineer's note:**  
For increased strength and stability in soft ground conditions, specify RootSpace modules to incorporate side panel inserts to tree pit perimeter

PROJECT

TREE PRODUCT PACKAGES

CLIENT

REV NO

A

DATE

FEB '17

SECTION A-A

SECTION B-B

DRAWING TITLE

TREE PIT SYSTEM INSTALLATION  
CONTINUOUS TREE TRENCH -  
ROOTSPACE & 5m TREE SPACING

DRAWING NUMBER

GBU 2006

SCALE

1:50 @ A3

DRAWN BY

TES



Northpoint, Compass Park, Bodiam,  
East Sussex, TN32 5BS  
Sales and Service: +44 (0)1580 830800  
Website: [www.greenblueurban.com](http://www.greenblueurban.com)